

Kit Number **YHVA280-3pxm-A-000**

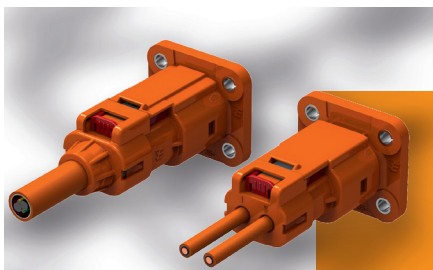

AMP+ High Current Connectors and Headers

# AMP+ HVA 280

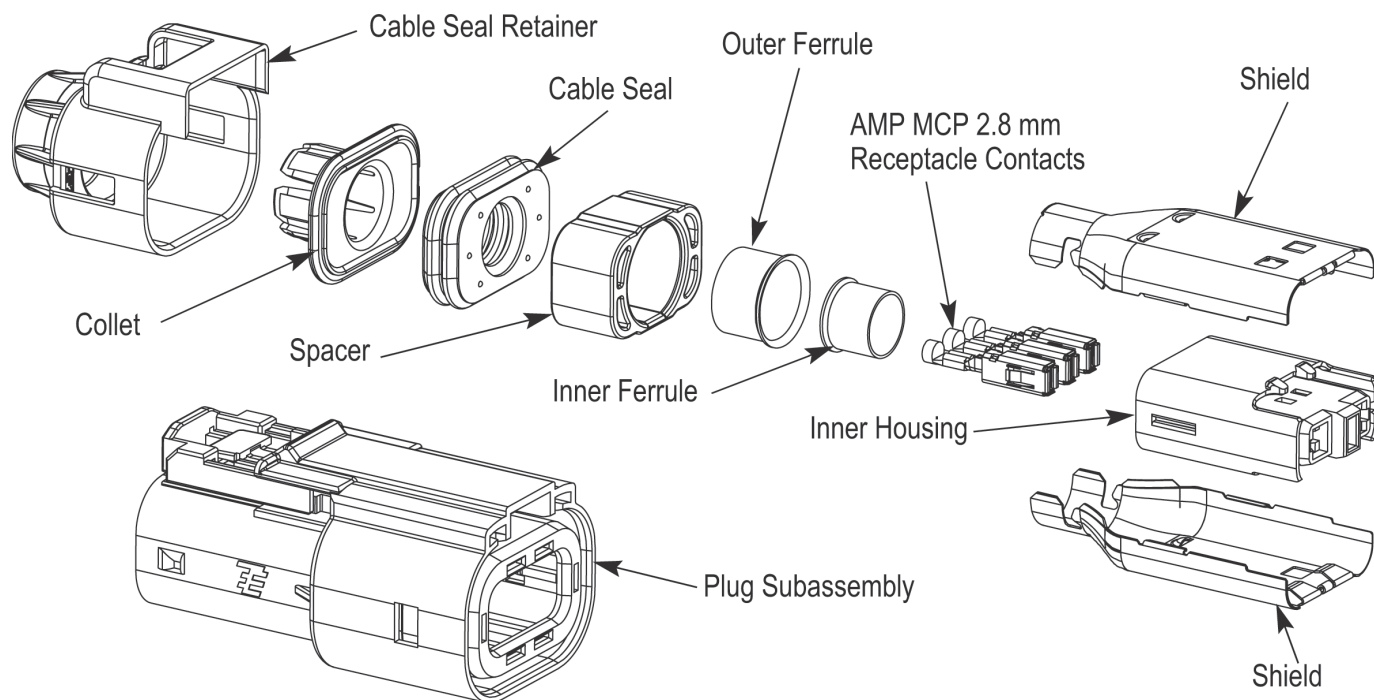

## Connector Series

## AMP+ HVA280

Positions	3
Cable Size	2.5 mm <sup>2</sup>
Wire Type	Multicore
HVIL	Not present
Key Coding	A
Application Specification	114-32056
Product Specification	108-32020
Mating Header PN	
Outer Housing	2103247-1
Inner housing	2103321-1

## Bill of Materials

Part Number	Description	Quantity
4-2103015-1	Plug subassy, finger accessible with CPA, Key A	1
2103306-1	Inner Housing	1
1-2103157-2	Shield, Plug, Ag	2
1587723-2	Ferrule, Inner	1
1587724-2	Ferrule, Outer	1
2103153-1	Spacer	1
2103154-2	Cable Seal	1
2103155-2	Collet	1
2103013-2	Cable Seal Retainer	1
1-968851-3	AMP MCP 2.8 Terminal Female, Ag, >1.0-2.5 mm <sup>2</sup>	3

---

## DISCLAIMER

While TE Connectivity (TE) has made every reasonable effort to ensure the accuracy of the information in this document, TE does not guarantee that it is error-free, nor does TE make any other representation, warranty or guarantee that the information is accurate, correct, reliable or current. TE reserves the right to make any adjustments to the information contained herein at any time without notice.

TE expressly disclaims all implied warranties regarding the information contained herein, including, but not limited to, any implied warranties of merchantability or fitness for a particular purpose. The dimensions in this catalog are for reference purposes only and are subject to change without notice. Specifications are subject to change without notice. Consult TE for the latest dimensions and design specifications.

## TRADEMARKS

AMP+, AMP MCP, TE, TE Connectivity, and TE connectivity (logo) are trademarks.

Other product names, logos, and company names mentioned herein may be trademarks of their respective owners.

## COPYRIGHT

© 2019 TE Connectivity | All rights reserved.

5-1773982-1 | 09-2019

## CONTACT

### TE Connectivity

4849 Hempstead Station Drive | Kettering, OH 45429 | USA

Phone: +1 800 522 6752